



Method(e):

0941

10–60 mg/L C

20–80 %:

10

20

50

60 mg/L C



REF 985 094

1/2

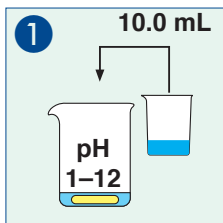

Probe / Sample  
Échant. / Muestra

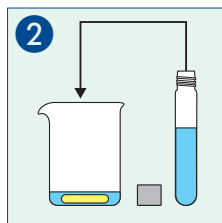

500 µL R0

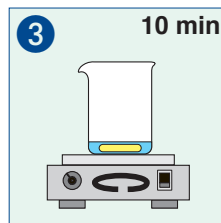

Rühren / Stirr  
Agiter / Agitar

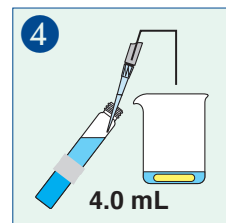

in Küvette / into tube  
dans cuve / en tubo

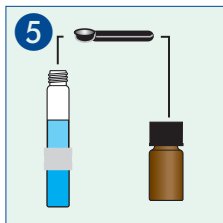

1  R2

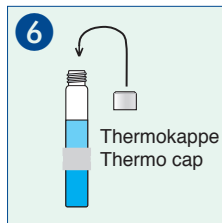

Schließen / Close  
Ferrar / Cerrar

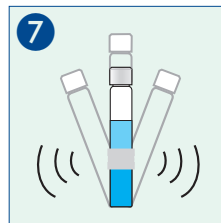

Schütteln / Shake  
Agiter / Agitar

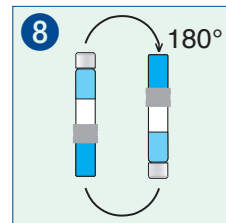

Drehen / Turn  
Retourner / Girar

A037329 / 985 094 / 1111



Method(e):

0941

10–60 mg/L C

20–80 %:

10

20

50

60 mg/L C



REF 985 094

2/2

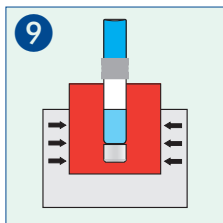

120 °C / 2 h

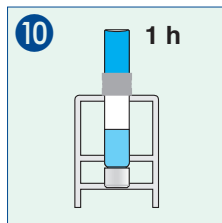

Abkühlen / Cool  
Refrroidir / Enfriar

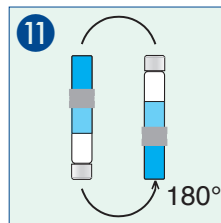

Drehen / Turn  
Retourner / Girar

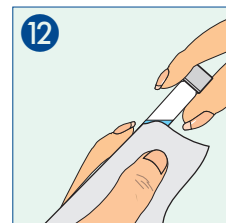

Säubern / Clean  
Nettoyer / Limpiar

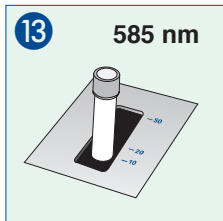

Messen / Measure  
Mesurer / Medir