



Method(e):

0931

2.0–25.0 mg/L C

20–80 %:

2.0 6.6 20.4 25.0 mg/L C



REF 985 093

1/2

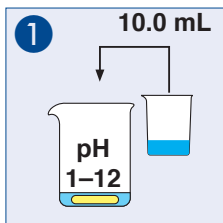

Probe / Sample
Échant. / Muestra

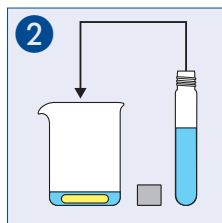

500 µL R0

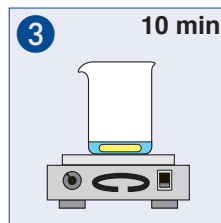

Rühren / Stirr
Agiter / Agitar

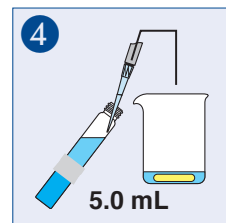

in Küvette / into tube
dans cuve / en tubo

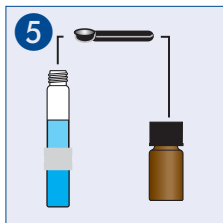

1  R2

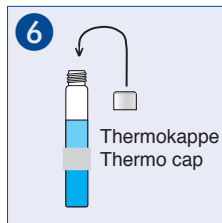

Schließen / Close
Fermar / Cerrar

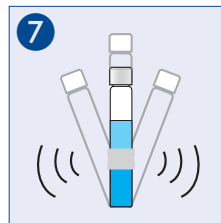

Schütteln / Shake
Agiter / Agitar

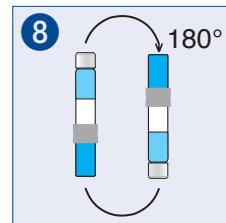

Drehen / Turn
Retourner / Girar

A037328 / 985 093 / 1111



Method(e):

0931

2.0–25.0 mg/L C

20–80 %:

2.0 6.6 20.4 25.0 mg/L C



REF 985 093

2/2

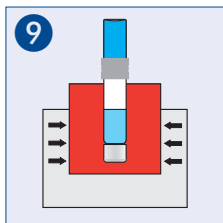

120 °C / 2 h

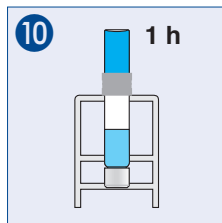

Abkühlen / Cool
Refridir / Enfriar

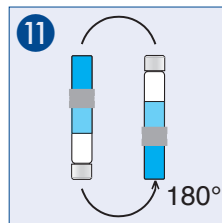

Drehen / Turn
Retourner / Girar

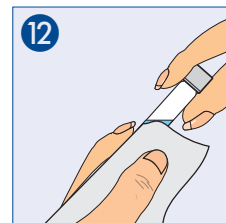

Säubern / Clean
Nettoyer / Limpiar

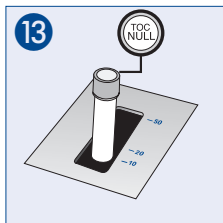

Null messen / Measure blank
Lecture blanc / Lectura blanco

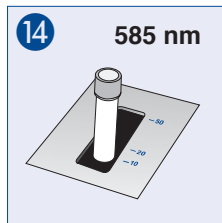

Messen / Measure
Mesurer / Medir