

TOC 25 COT

Test 0-93

REF 985 093



Rundküvettentest / Tube test

Test en cuves rondes / Prueba en cubeta cilíndrica

2.0–25.0 mg/L C

585 nm

Method(e) / Método

0931

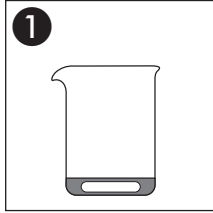

1
10.0 mL Probe
Sample
Echantillon
Muestra

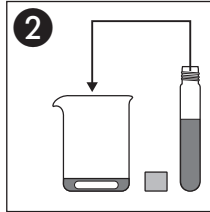

2
500 μ L R0

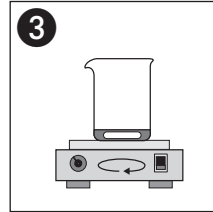

3
10 min Rühren
Stirr
Agiter
Agitar

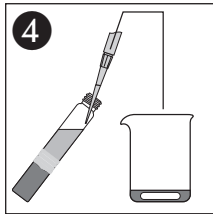

4
5.0 mL in TOC-Küvette
into tube TOC
dans cuve COT
en tubo TOC

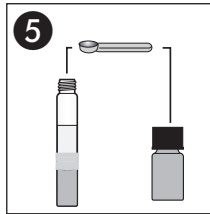

5
1 x R2

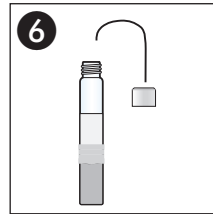

6
Thermokappe aufschrauben
Close with thermo cap
Fermer avec thermo cap
Cerrar con thermo cap

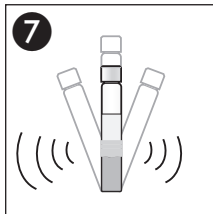

7
Schütteln
Shake
Agiter
Agitar

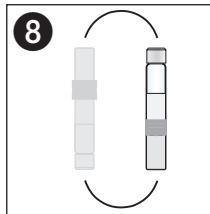

8
Küvette um 180° drehen
Turn tube upside down
Retourner tube
Girar tubo

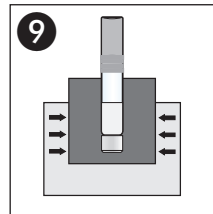

9
120 °C / 2 h