

Stärke 100

Starch / Amidon / Almidón

Test 0-85

REF 985 085



Rundküvettentest / Tube test

Test en cuves rondes / Prueba en cubeta cilíndrica

540 nm

Method(e) / Método

0851

5–100 mg/L

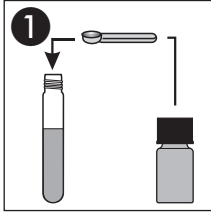

1 x R2

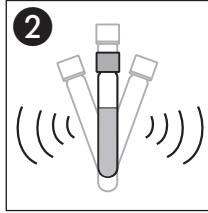

Schütteln
Shake
Agiter
Agitar

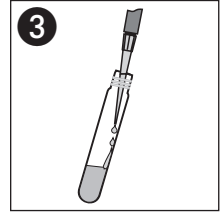

1.0 mL R3

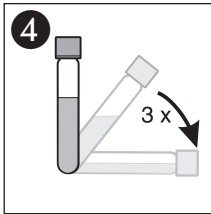

Umschwenken
Shake gently
Secouer légèrement
Mezclar volteándolo

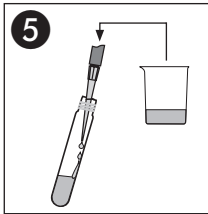

4.0 mL Probe
Sample
Echantillon
Muestra

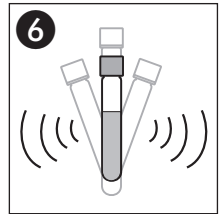

Schütteln
Shake
Agiter
Agitar

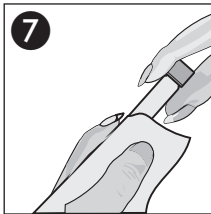

Säubern
Clean
Nettoyer
Limpiar

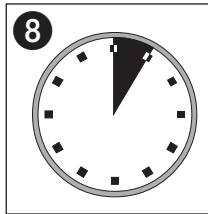

5'00 min

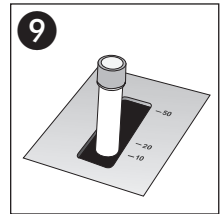

Messung
Measurement
Mesure
Medición