

ortho-Phosphat 5

ortho Phosphate / orto Fosfato

Test 0-81

REF 985 081



Rundküvettentest / Tube test

Test en cuves rondes / Prueba en cubeta cilíndrica

0.20–5.00 mg/L PO₄-P

0.5–15.0 mg/L PO₄³⁻

690 nm

Method(e) / Método

0815

0816

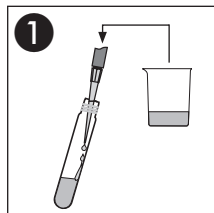

1
1.0 mL Probe
Sample
Echantillon
Muestra

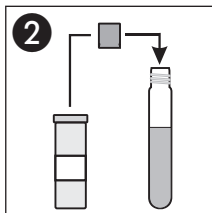

2
1 x NANOFIX R3

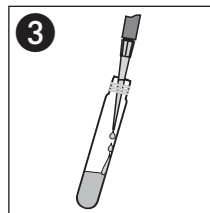

3
200 µL R4

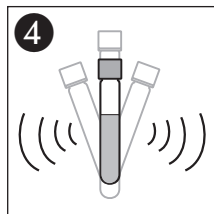

4
Schütteln
Shake
Agiter
Agitar

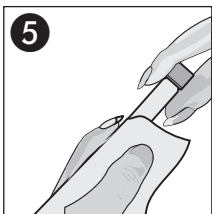

5
Säubern
Clean
Nettoyer
Limpiar

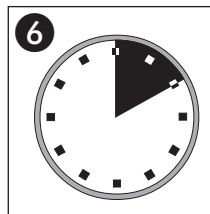

6
10'00 min

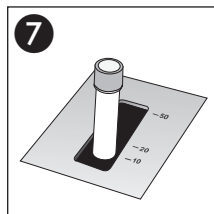

7
Messung
Measurement
Mesure
Medición