

gesamt-Phosphat 50

total Phosphate / Fosfato total

Test 0-79

REF 985 079



Rundküvettentest / Tube test

Test en cuves rondes / Prueba en cubeta cilíndrica

10.0–50.0 mg/L P

30–150 mg/L PO_4^{3-}

23–110 mg/L P_2O_5

436 nm

Method(e) / Método

0791

0792

0793

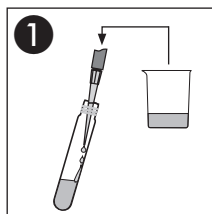

4.0 mL Probe
Sample
Echantillon
Muestra

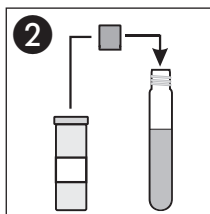

1 x NANOFIX R2

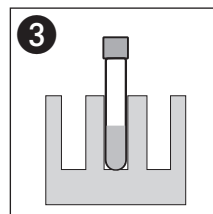

120 °C / 30 min
oder / or / ou / o
100 °C / 1 h

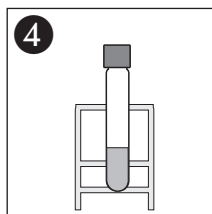

Abkühlen lassen
Allow to cool
Laisser refroidir
Dejar enfriar

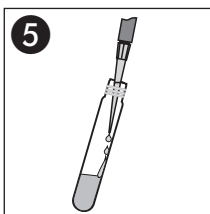

1.0 mL R3

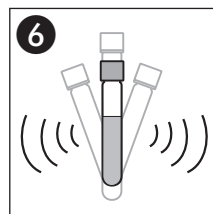

Schütteln
Shake
Agiter
Agitar

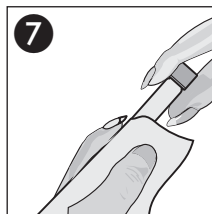

Säubern
Clean
Nettoyer
Limpiar

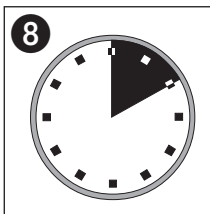

10'00 min

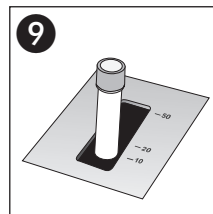

Messung
Measurement
Mesure
Medición