

# ortho-Phosphat 1

## ortho Phosphate / orto Fosfato

**Test 0-76**

REF 985 076



Rundküvettentest / Tube test

Test en cuves rondes / Prueba en cubeta cilíndrica

0.05–1.50 mg/L PO<sub>4</sub>-P0.2–5.0 mg/L PO<sub>4</sub><sup>3-</sup>

690 nm

Method(e) / Método

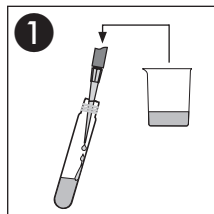
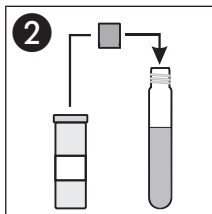
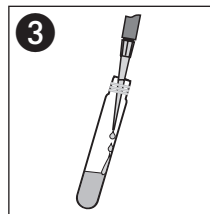
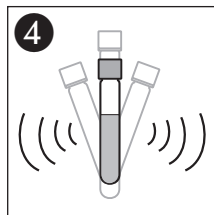
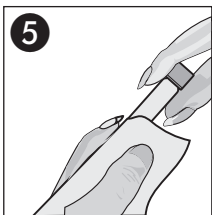
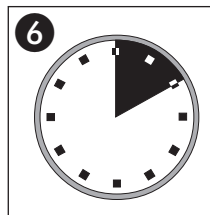
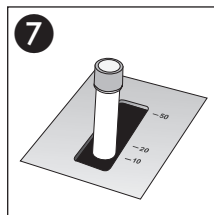
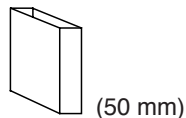
**0765****0766****1**  
4.0 mL Probe  
Sample  
Echantillon  
Muestra**2**  
1 x NANOFIX R3**3**  
200 µL R4**4**  
Schütteln  
Shake  
Agiter  
Agitar**5**  
Säubern  
Clean  
Nettoyer  
Limpiar**6**  
10'00 min**7**  
Messung  
Measurement  
Mesure  
Medición

Method(e) / Método

0.010–0.800 mg/L PO<sub>4</sub>-P**1765**0.03–2.50 mg/L PO<sub>4</sub><sup>3-</sup>**1766**siehe Gebrauchsanweisung / see instructions for use /  
voir mode d'emploi / ver instrucciones de uso