

# gesamt-Phosphat 1

## total Phosphate / Fosfato total

### Test 0-76

REF 985 076



Rundküvettentest / Tube test  
 Test en cuves rondes / Prueba en cubeta cilíndrica

690 nm

Method(e) / Método

0.05–1.50 mg/L P  
 0.2–5.0 mg/L PO<sub>4</sub><sup>3-</sup>

**0761**  
**0762**

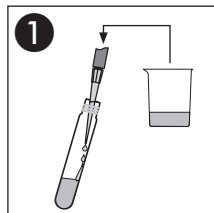

**4.0 mL** Probe  
 Sample  
 Echantillon  
 Muestra

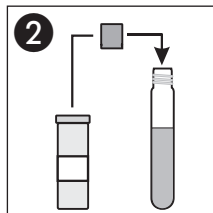

**1 x NANOFIX R2**

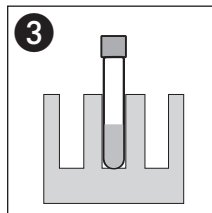

**120 °C / 30 min**  
 oder / or / ou / o  
**100 °C / 1 h**

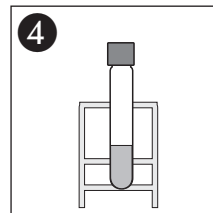

Abkühlen lassen  
 Allow to cool  
 Laisser refroidir  
 Dejar enfriar

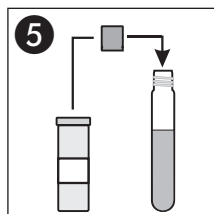

**1 x NANOFIX R3**

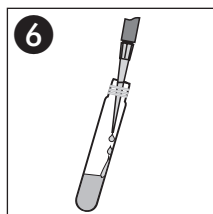

**200 µL R4**

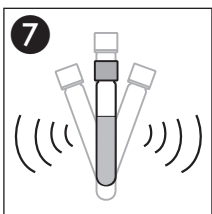

Schütteln  
 Shake  
 Agiter  
 Agitar

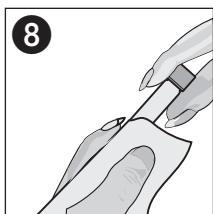

Säubern  
 Clean  
 Nettoyer  
 Limpiar

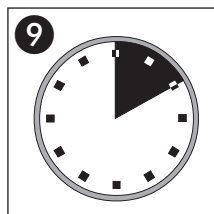

**10'00 min**

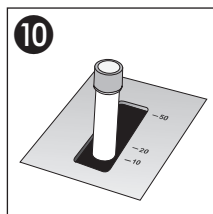

Messung  
 Measurement  
 Mesure  
 Medición

0.010–0.800 mg/L P  
 0.03–2.50 mg/L PO<sub>4</sub><sup>3-</sup>

Method(e) / Método

**1761**  
**1762**

siehe Gebrauchsanweisung / see instructions for use /  
 voir mode d'emploi / ver instrucciones de uso

