

# Nickel 7

## Níquel

**Test 0-61**

REF 985 061



Rundküvettentest / Tube test

Test en cuves rondes / Prueba en cubeta cilíndrica

0.10–7.00 mg/L Ni<sup>2+</sup>

470 nm

Method(e) / Método

**0611**

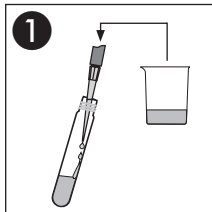

**1**  
5.0 mL Probe  
Sample  
Echantillon  
Muestra

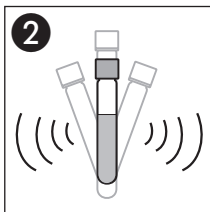

**2**  
Schütteln  
Shake  
Agiter  
Agitar

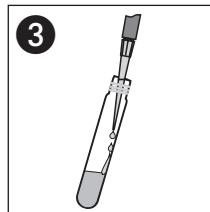

**3**  
1.0 mL R2

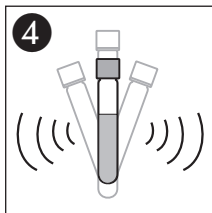

**4**  
Schütteln  
Shake  
Agiter  
Agitar

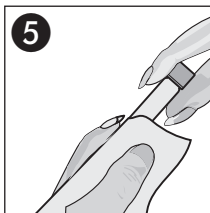

**5**  
Säubern  
Clean  
Nettoyer  
Limpiar

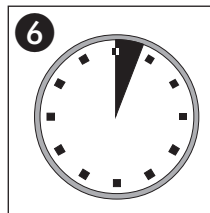

**6**  
3'00 min

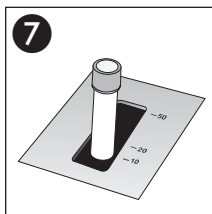

**7**  
Messung  
Measurement  
Mesure  
Medición

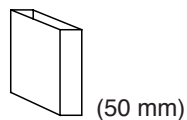

Method(e) / Método

**1611**

0.02–1.00 mg/L Ni<sup>2+</sup>

siehe Gebrauchsanweisung / see instructions for use /  
voir mode d'emploi / ver instrucciones de uso