

gesamt-Phosphat 45

total Phosphate / Fosfato total

Test 0-55

REF 985 055



Rundküvettentest / Tube test

Test en cuves rondes / Prueba en cubeta cilíndrica

690 nm

Method(e) / Método

0551

0552

0553

5.0–50.0 mg/L P
15–150 mg/L PO_4^{3-}
10–115 mg/L P_2O_5

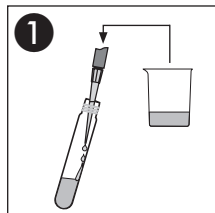

200 μL Probe
Sample
Echantillon
Muestra

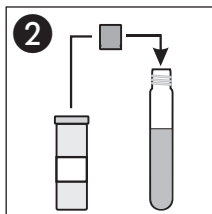

1 x **NANOFIX R2**

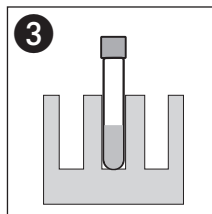

120 °C / 30 min
oder / or / ou / o
100 °C / 1 h

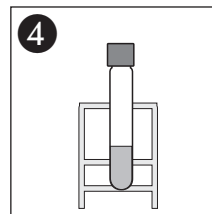

Abkühlen lassen
Allow to cool
Laisser refroidir
Dejar enfriar

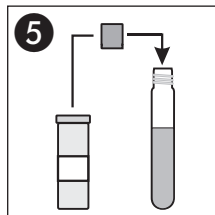

1 x **NANOFIX R3**

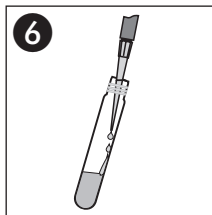

200 μL R4

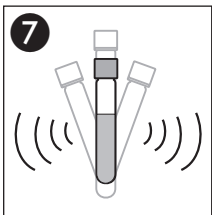

Schütteln
Shake
Agiter
Agitar

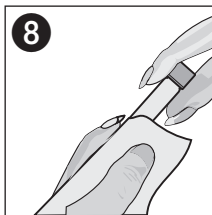

Säubern
Clean
Nettoyer
Limpiar

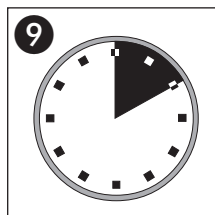

10'00 min

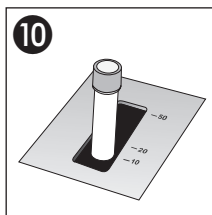

Messung
Measurement
Mesure
Medición