

# Härte Ca/Mg

## Hardness / Dureté / Durezza

Rundküvettentest / Tube test

Test en cuves rondes / Prueba en cubeta cilíndrica

5–50 mg/L Mg<sup>2+</sup> / 10–100 mg/L Ca<sup>2+</sup>

1.0–20.0 °d

1.0–25.0 °e

2.0–36.0 °f

0.2–3.6 mmol/L

20–350 mg/L CaCO<sub>3</sub>

Gesamthärte / Total hardness / Dureté total / Durezza total:

### Test 0-44

REF 985 044



540 nm

Method(e) / Método

0441 / 0442

0443

0444

0445

0446

0447

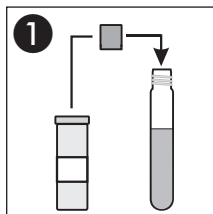

1 x NANOFIX R2

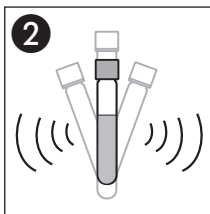

Kräftig schütteln  
Shake well  
Bien agiter  
Agitar intensamente

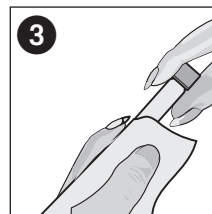

Säubern  
Clean  
Nettoyer  
Limpiar

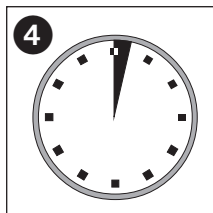

2'00 min

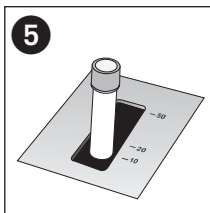

Null  
Zero  
Zéro  
Cero

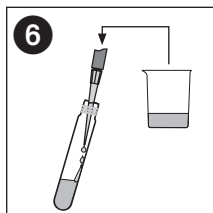

200 µL Probe  
Sample  
Echantillon  
Muestra

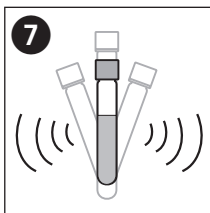

Schütteln  
Shake  
Agiter  
Agitar

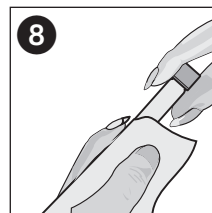

Säubern  
Clean  
Nettoyer  
Limpiar

# Härte Ca/Mg

Hardness/Dureté/Dureza

**Test 0-44**

REF 985 044

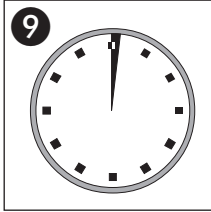

1'00 min

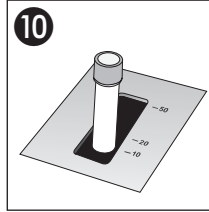

Messung 1  
Measurement  
Mesure  
Medición

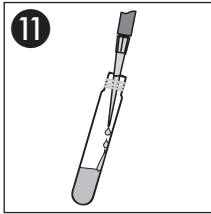

200  $\mu$ L R3

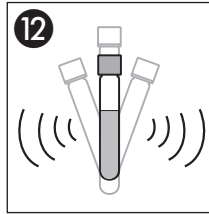

Schütteln  
Shake  
Agiter  
Agitar

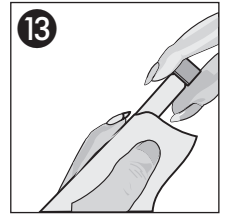

Säubern  
Clean  
Nettoyer  
Limpiar

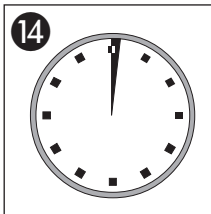

1'00 min

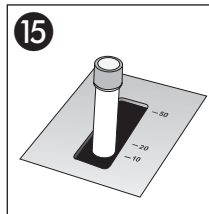

Messung 2  
Measurement  
Mesure  
Medición