

Eisen 3

Iron / Fer / Hierro

Test 0-37

REF 985 037



Rundküvettentest / Tube test

Test en cuves rondes / Prueba en cubeta cilíndrica

0.10–3.00 mg/L Fe

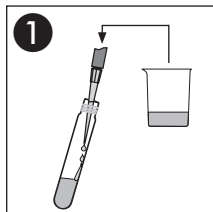

1
4.0 mL Probe
Sample
Echantillon
Muestra

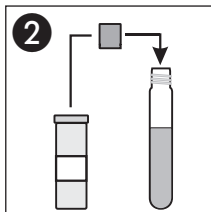

2
1 x **NANOFIX R2**

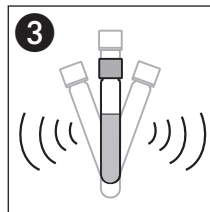

3
Schütteln
Shake
Agiter
Agitar

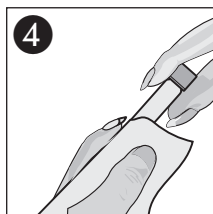

4
Säubern
Clean
Nettoyer
Limpiar

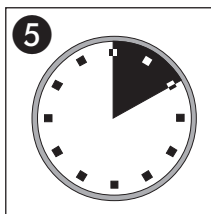

5
10'00 min

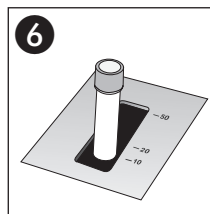

6
Messung
Measurement
Mesure
Medición

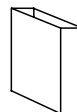

(50 mm)

Method(e) / Método

1371

0.02–1.00 mg/L Fe

siehe Gebrauchsanweisung / see instructions for use / voir mode d'emploi / ver instrucciones de uso