

DEHA 1

Test 0-35

REF 985 035



Rundküvettentest / Tube test

Test en cuves rondes / Prueba en cubeta cilíndrica

0.05–1.00 mg/L DEHA

540 nm

Method(e) / Método

0351

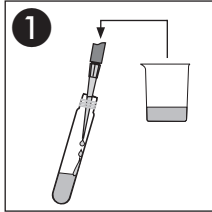

4.0 mL Probe
Sample
Echantillon
Muestra

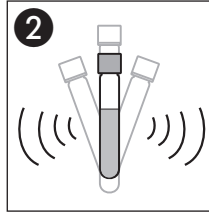

Schütteln
Shake
Agiter
Agitar

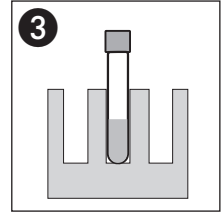

100 °C / 15 min

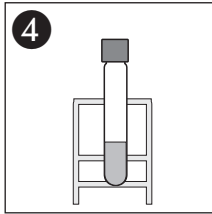

Abkühlen lassen
Allow to cool
Laisser refroidir
Dejar enfriar

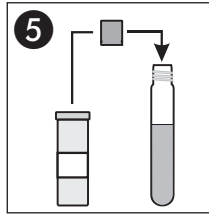

1 x NANOFIX R2

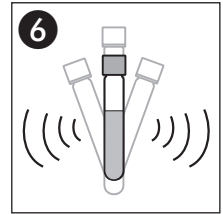

Schütteln
Shake
Agiter
Agitar

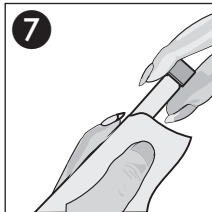

Säubern
Clean
Nettoyoy
Limpiar

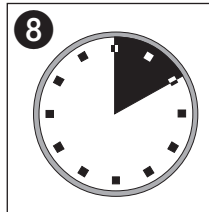

10'00 min

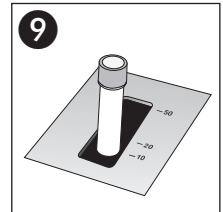

Messung
Measurement
Mesure
Medición