

Chlorid 200

Chloride/Chlorure/Cloruro

Test 0-19

REF 985 019



Rundküvettentest / Tube test

Test en cuves rondes / Prueba en cubeta cilíndrica

5–200 mg/L Cl⁻

470 nm

Method(e) / Método

0191

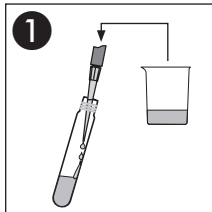

1
1.0 mL Probe
Sample
Echantillon
Muestra

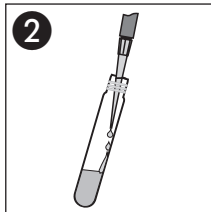

2
1.0 mL R2

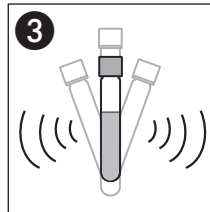

3
Schütteln
Shake
Agiter
Agitar

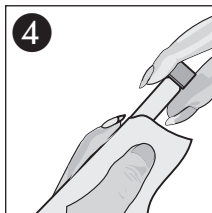

4
Säubern
Clean
Nettoyer
Limpiar

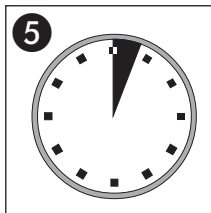

5
3'00 min

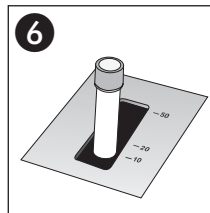

6
Messung
Measurement
Mesure
Medición