

Chlor/Ozon 2

Chlorine/Chlore/Cloro // Ozone/Ozono

Test 0-17

REF 985 017



0.05–2.00 mg/L O₃

Ozon/Ozone/Ozono:

Method(e) / Método

0173

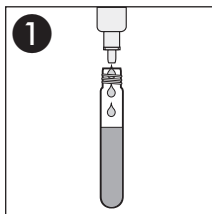

1
3 x R2

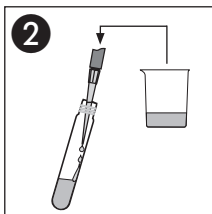

2
5 mL Probe
Sample
Echantillon
Muestra

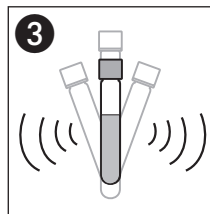

3
Schütteln
Shake
Agiter
Agitar

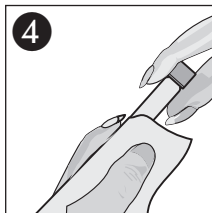

4
Säubern
Clean
Nettoyer
Limpiar

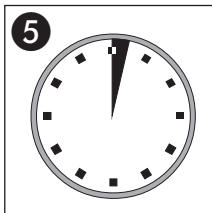

5
2'00 min

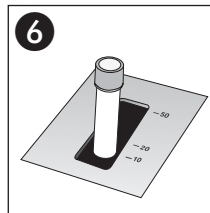

6
Messung
Measurement
Mesure
Medición