

# Chlor/Ozon 2

## Chlorine/Chlore/Cloro//Ozone/Ozono

**Test 0-17**

REF 985 017



Rundküvettentest / Tube test

Test en cuves rondes / Prueba en cubeta cilíndrica

0.05–2.50 mg/L Cl<sub>2</sub>

0.09–4.80 mg/L ClO<sub>2</sub>

Freies Chlor / Free Chlorine / Chlore libre / Cloro libre:

Chlordioxid / Chlorine dioxide / Dioxyde de chlore / Cloro dióxido:

540 nm

Method(e) / Método

0171

0174

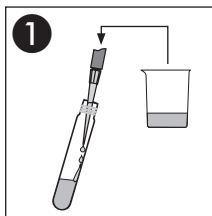

**1**  
4.0 mL Probe  
Sample  
Echantillon  
Muestra

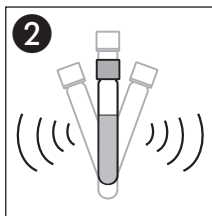

**2**  
Kräftig schütteln  
Shake well  
Bien agiter  
Agitar intensamente

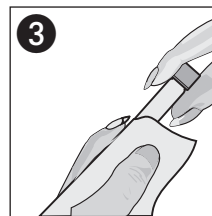

**3**  
Säubern  
Clean  
Nettoyer  
Limpiar

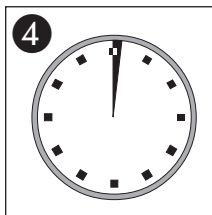

**4**  
1'00 min

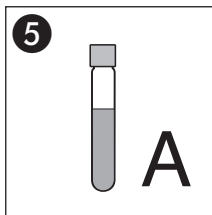

**5**  
Lösung A  
Solution A  
Solution A  
Solución A

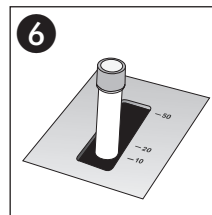

**6**  
Messung  
Measurement  
Mesure  
Medición