

# Blei 5

## Lead/Plomb/Plomo

**Test 0-09**

REF 985 009



Rundküvettest / Tube test

Test en cuves rondes / Prueba en cubeta cilíndrica

0.10–5.00 mg/L Pb<sup>2+</sup>

0.10–5.00 mg/L Pb

Messwert A / Sample value A / Valeur A / Valor de medición A:

520 nm

Method(e) / Método

0091

0093\*

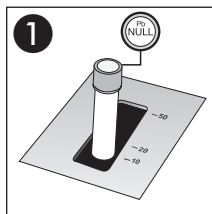

NULL messen  
Measure blank  
Lecture blanc  
Lectura blanco

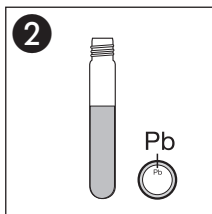

Blei-Rundküvette  
Test tube **Lead**  
Cuve ronde **Plomb**  
Tubo de test **Plomo**

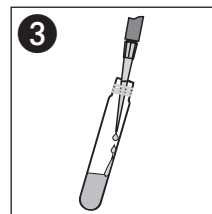

200 µL R2

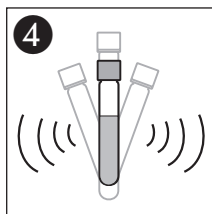

Schütteln  
Shake  
Agiter  
Agitar

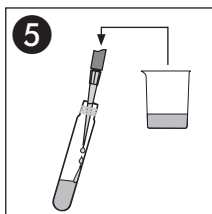

4.0 mL Probe  
Sample  
Echantillon  
Muestra

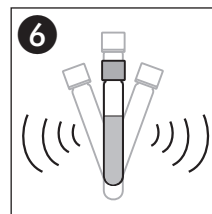

Schütteln  
Shake  
Agiter  
Agitar

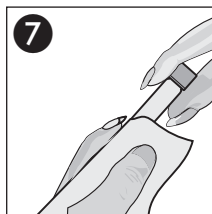

Säubern  
Clean  
Nettoyer  
Limpiar

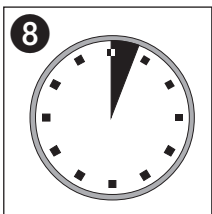

3'00 min

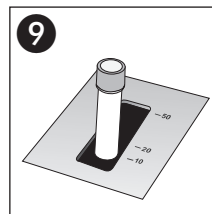

Messwert A  
Value A  
Valeur A  
Valor A

# Blei 5

## Lead/Plomb/Plomo

**Test 0-09**

REF 985 009



Messwert B / Sample value B / Valeur B / Valor de medición B:

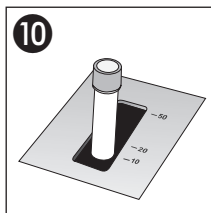

Messwert A = Null  
Value A = Zero  
Valeur A = Zéro  
Valor A = Cero

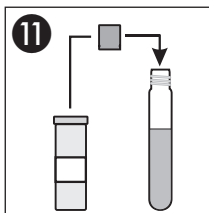

1 x **NANOFIX R3**

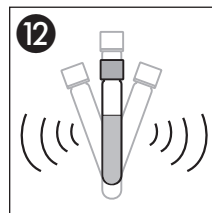

Schütteln  
Shake  
Agiter  
Agitar

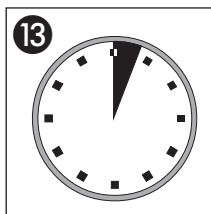

**3'00 min**

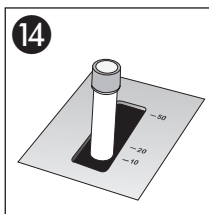

Messwert B  
Value B  
Valeur B  
Valor B

\* Für Verwendung von Aufschluss-Set / for use of crack set / pour l'utilisation du set de minéralisation /  
Para la utilización del kit de descomposición

**REF 918 08**