

NANOCOLOR® TOC 600 COT

585 nm

Method(e) / Método

0991

40 - 600 mg/l C

Test 0-99

REF 985 099

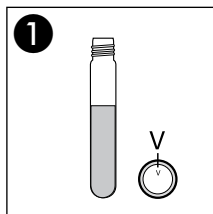

1
Verdünnungsküvette
Dilution test tube
Cuve ronde de dilution
Tubo de dilución

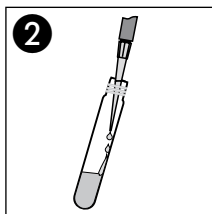

2
1.0 ml Probe
Sample
Echantillon
Muestra Agitar

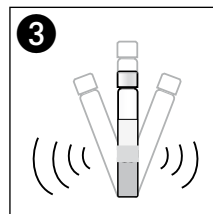

3
Schütteln
Shake
Agiter
Agitar

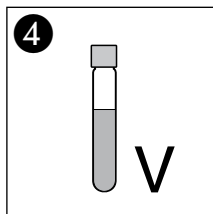

4
Verdünnungslösung V
Diluted solution V
Solution de dilution V
Solución de dilución V

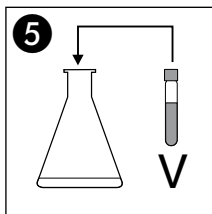

5
Verdünnungslösung
Diluted solution
Solution de dilution
Solución de dilución

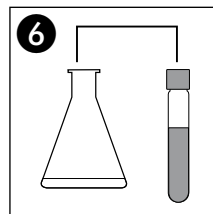

6
Verdünnungslösung
Diluted solution
Solution de dilution
Solución de dilución

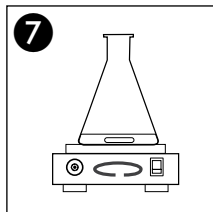

7
10 min Rühren
Stirr
Agiter
Agitar

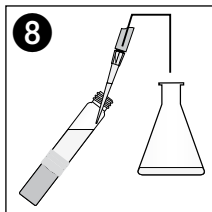

8
4.0 ml in TOC-Küvette
into tube TOC
dans cuve COT
en tubo TOC

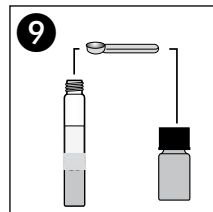

9
1 x R2

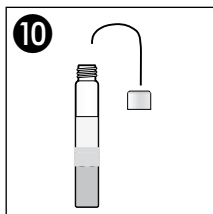

10
Thermokappe aufschrauben
Close with thermo cap
Fermer avec thermo cap
Cerrar con thermo cap

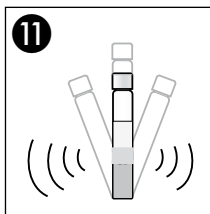

11
Schütteln
Shake
Agiter
Agitar

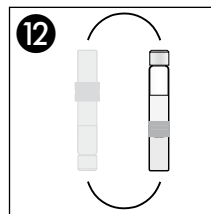

12
Küvette um 180° drehen
Turn tube upside down
Retourner tube
Girar tubo

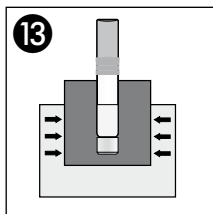

13
120 °C / 2 h

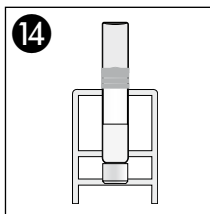

14
60 min Abkühlen lassen
Allow to cool
Laisser refroidir
Dejar enfriar

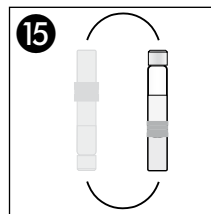

15
Küvette um 180° drehen
Turn tube upside down
Retourner tube
Girar tubo

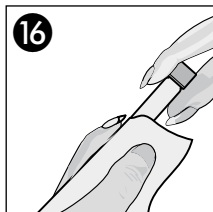

16
Säubern
Clean
Nettoyer
Limpiar

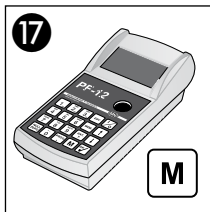

17
Messung
Measurement
Mesure
Medición

Meerwasser
Sea water
Eau de mer
Agua de mar

