

NANOCOLOR® gesamt-Phosphat 5

total Phosphate(s) / Fosfato total

Test 0-81

REF 985 081

690 nm

Method(e) / Método

0811 0.20 - 5.00 mg/l P
0812 0.5 - 15.0 mg/l PO₄³⁻

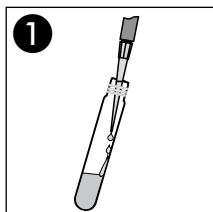

1
1.0 ml Probe
Sample
Enchantillon
Muestra

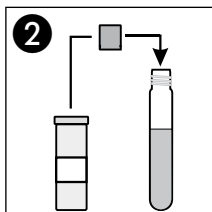

2
1 x NANOFIX R2

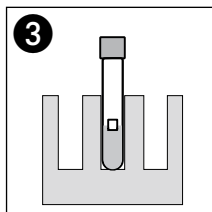

3
120 °C / 30 min
oder / or / ou / o
100 °C / 1 h

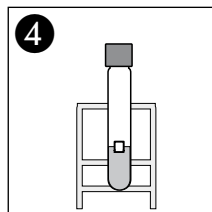

4
Abkühlen lassen
Allow to cool
Laisser refroidir
Dejar enfriar

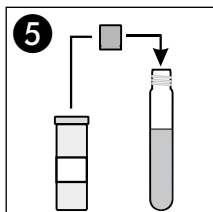

5
1 x NANOFIX R3

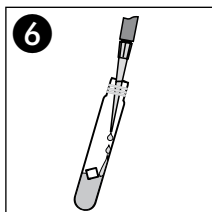

6
200 µl R4

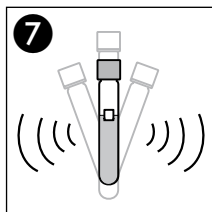

7
Schütteln
Shake
Agiter
Agitar

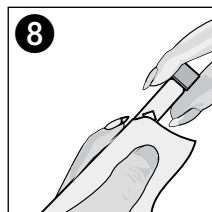

8
Säubern
Clean
Nettoyer
Limpiar

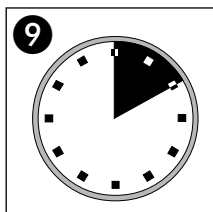

9
10'00 min

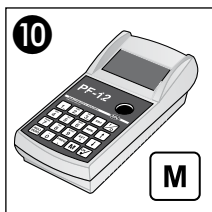

10
Messung
Measurement
Mesure
Medición

Meerwasser
Sea water
Eau de mer
Agua de mar

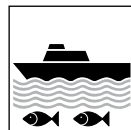

NANOCOLOR® ortho-Phosphat 5

ortho Phosphate(s) / orto Fosfato

Test 0-81A

REF 985 081

690 nm

Method(e) / Método

0815 0.20 - 5.00 mg/l $\text{PO}_4\text{-P}$
0816 0.5 - 15.0 mg/l $\text{PO}_4\text{-P}$

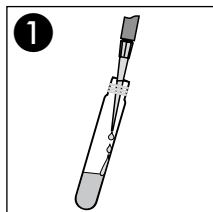

1
1.0 ml Probe
Sample
Enchantillon
Muestra

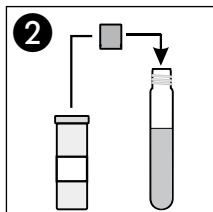

2
1 x NANOFIX R3

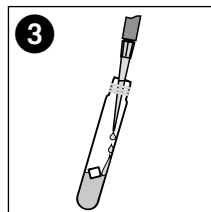

3
200 µl R4

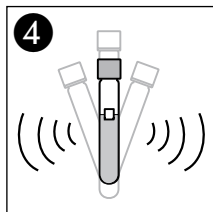

4
Schütteln
Shake
Agiter
Agitar

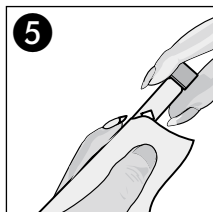

5
Säubern
Clean
Nettoyer
Limpiar

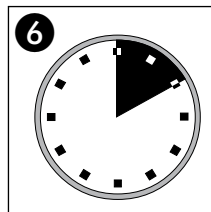

6
10'00 min

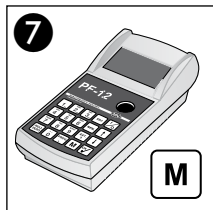

Messung
Measurement
Mesure
Medición

Meerwasser
Sea water
Eau de mer
Agua de mar

