

NANOCOLOR® *gesamt-Phosphat 1*

total Phosphate(s) / Fosfato total

Test 0-76

REF 985 076

690 nm

Method(e) / Método

0761

0.05 - 1.50 mg/l P

0762

0.2 - 5.0 mg/l PO₄³⁻

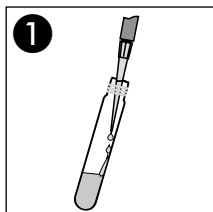

4.0 ml Probe
Sample
Enchantillon
Muestra

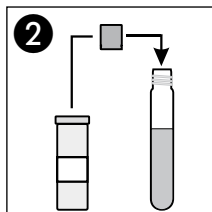

1 x NANOFIX R2

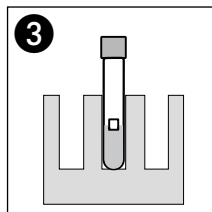

120 °C / 30 min
oder / or / ou / o
100 °C / 1 h

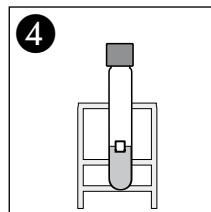

Abkühlen lassen
Allow to cool
Laisser refroidir
Dejar enfriar

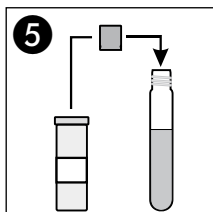

1 x NANOFIX R3

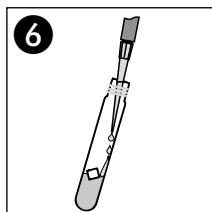

200 µl R4

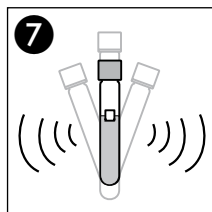

Schütteln
Shake
Agiter
Agitar

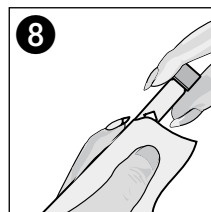

Säubern
Clean
Nettoyer
Limpiar

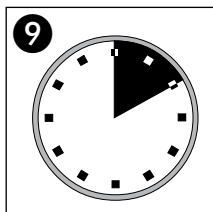

10'00 min

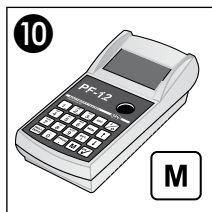

Messung
Measurement
Mesure
Medición

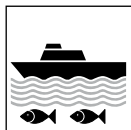

Meerwasser
Sea water
Eau de mer
Agua de mar

NANOCOLOR® ortho-Phosphat 1

ortho Phosphate(s) / orto Fosfato

Test 0-76A

REF 985 076

690 nm

Method(e) / Método

0765

0.05 - 1.50 mg/l PO₄-P

0766

0.2 - 5.0 mg/l PO₄³⁻

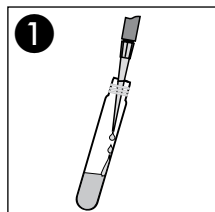

1
4.0 ml Probe
Sample
Enchantillon
Muestra

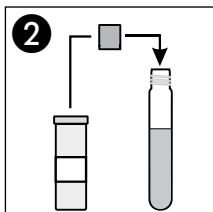

2
1 x NANOFIX R3

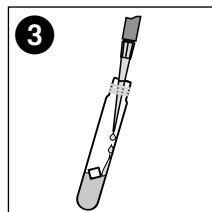

3
200 µl R4

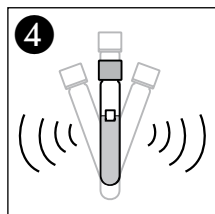

4
Schütteln
Shake
Agiter
Agitar

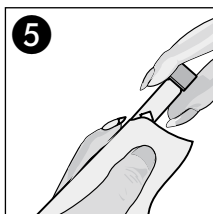

5
Säubern
Clean
Nettoyer
Limpiar

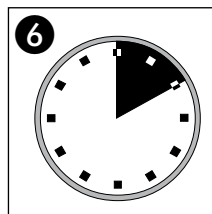

6
10'00 min

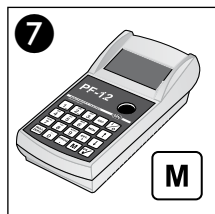

Messung
Measurement
Mesure
Medición

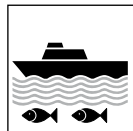

Meerwasser
Sea water
Eau de mer
Agua de mar